

# 2012 Tax Savings on SP Central Telepharmacy

Consult your tax advisor about a possible  
carryback or carryforward of tax savings.

ScriptPro's SP Central Telepharmacy enables pharmacies to conduct high-quality, safe, and efficient telepharmacy operations. Real-time video/audio/data connections allow pharmacists at a central pharmacy to oversee the entire dispensing process at a remote location.

Now is the time to upgrade your pharmacy with ScriptPro automation. You may qualify for important tax deductions, up to \$139,000 under Section 179—allowing you to save big on capital equipment placed in service in 2012.

## Pharmacy currently using SP Central Workflow

## Pharmacy without SP Central Workflow

2012 Tax Calculation	
ScriptPro SP Central Telepharmacy <sup>1</sup>	\$ 56,106
<b>Maximum Sec 179</b> \$139,000 = maximum in 2012	\$ 56,106
<b>50% Bonus 1<sup>st</sup> Year Depreciation</b>	\$ 0
<b>Normal 1<sup>st</sup> Year Depreciation</b>	\$ 0
<b>Total 1<sup>st</sup> Year Deduction</b>	\$ 56,106
<b>Tax Savings</b> \$56,106 x 40% tax rate	\$ 22,442
<b>Net Cost of</b> \$56,106 less all tax deductions	<b>\$ 33,664</b>

2012 Tax Calculation	
ScriptPro SP Central Telepharmacy <sup>1</sup>	\$ 114,101
<b>Maximum Sec 179</b> \$139,000 = maximum in 2012	\$ 114,101
<b>50% Bonus 1<sup>st</sup> Year Depreciation</b>	\$ 0
<b>Normal 1<sup>st</sup> Year Depreciation</b>	\$ 0
<b>Total 1<sup>st</sup> Year Deduction</b>	\$ 114,101
<b>Tax Savings</b> \$114,101 x 40% tax rate	\$ 45,640
<b>Net Cost of</b> \$114,101 less all tax deductions	<b>\$ 68,461</b>

<sup>1</sup> See reverse side for description of recommended equipment.

**Note:** ScriptPro presents the above analysis for example purposes only. The calculations shown are not intended to be tax advice and may not be representative of the actual tax effects of any specific transaction. Taxpayers seeking to determine the tax results of contemplated transactions should consult their tax advisors.

**“ScriptPro Telepharmacy allows a support pharmacist the visual and audio oversight combined with barcode scanning to safely and accurately dispense prescriptions to patients remotely. I can say with confidence that ScriptPro provides the best Telepharmacy product on the market today.”**

—Tim Gallagher, R.Ph., Vice President of Pharmacy Operations  
Astrup Drug, MN

**ScriptPro**<sup>®</sup>

**Pharmacy Automation**

5828 Reeds Road, Mission, KS 66202-2740 • 800.606.7628 • 913.384.1008 • www.scriptpro.com

# SP Central Telepharmacy

Recommended ScriptPro equipment for a pharmacy supporting one remote location:

## Pharmacy currently using SP Central Workflow

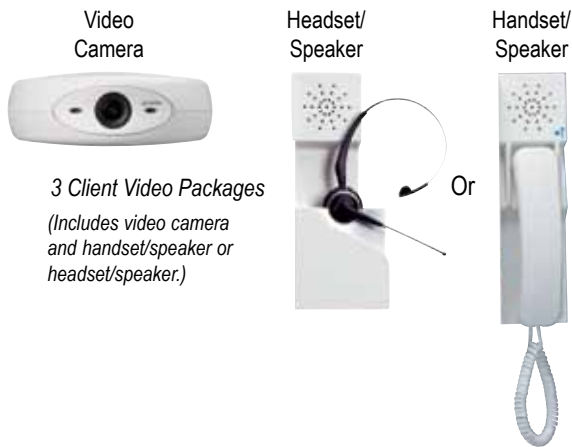
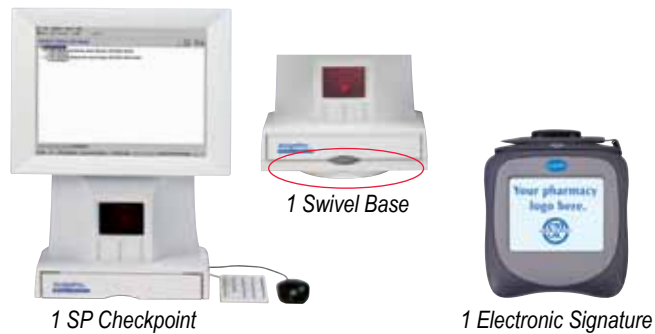

## Pharmacy without SP Central Workflow

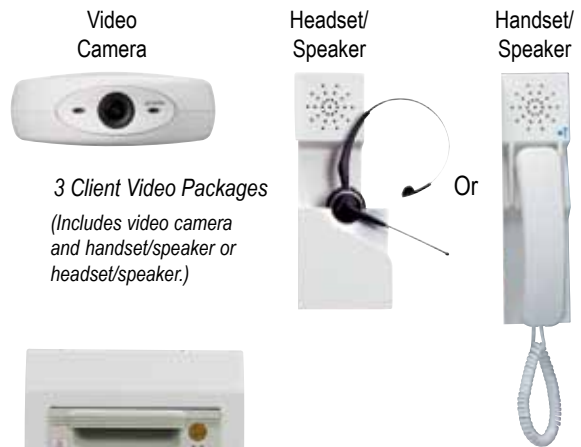
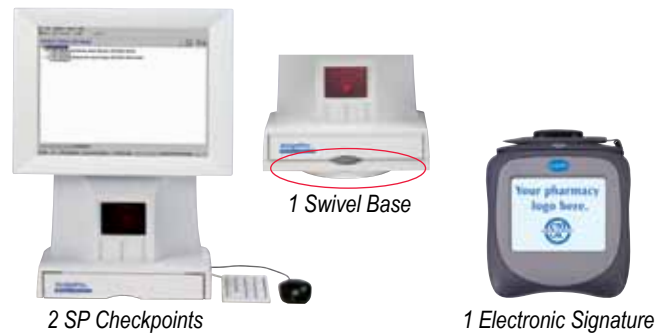

**ScriptPro®**

**Pharmacy Automation**